

# HID / INCANDESCENT LAMP HOLDERS



The 309 Series Lightscape bullet is available with integral metal halide ballastry. The bullet shape blends with other landscape elements allowing use in many applications. The weathertight die cast aluminum construction and 1/2" swivel knuckle allow aiming at virtually any angle. The reinforced fiberglass ballast housing is watertight and will provide many years of service. Ideally suited for landscape and signage illumination.

The 103 Series cast aluminum, bell-shaped lampholders are gasketed for outdoor applications and are available in a choice of three finishes. All units can be aimed in any position for maximum utilization when illuminating low level landscaping, trees, or signage.



## Fixture Specifications

### FEATURES

#### LAMP HEAD

- Die cast aluminum lamp housing with 1/2" swivel knuckle
- Protective clear glass lens sealed to extension collar (309 Series)
- Finished in weatherproof powder-coat paint
- Shipped less lamp
- UL listed for wet locations

#### BALLAST BOX (309 SERIES ONLY)

- Fiberglass reinforced polyester composite housing and cover
- Two 1/2 - 14 NPS conduit hubs for thru-wiring capability
- Requires 125° leads in box
- Silicone gasketed cover

### DIMENSIONS

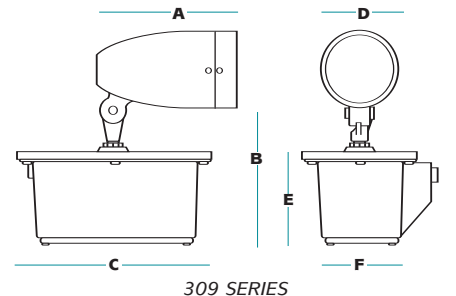

A	B	C	D	E	F
9.0"	9.0"	13.25"	5.5"	6.0"	9.0"

### ORDERING INFORMATION

Catalog Number	Wattage	Voltage	Input Watts	Amps		Weight	
				Start	Oper	lbs.	kg
<b>METAL HALIDE</b>							
<b>309-8H</b> (black)	100HPF	120/277	129	1.2	1.2	16.0	7.2
<b>309-7H</b> (black)	70HPF	120/277/347	95	0.8	0.9	16.0	7.2

### ORDERING INFORMATION

Medium base lampholders for PAR-38, A21, R-30 lamps (150 watt maximum!)

Catalog Number	Description	Gasket	Finish	Weight	
				lbs.	kg
<b>103-7</b>	Swivel Knuckle Mount, 6" leads	Silicone	Gray	1.25	0.6
<b>103-72</b>	Swivel Knuckle Mount, 6" leads	Silicone	Black	1.25	0.6
<b>103-73</b>	Swivel Knuckle Mount, 6" leads	Silicone	Garden Green	1.25	0.6

NOTE: Lamps not included; infrared or heat lamps not recommended.

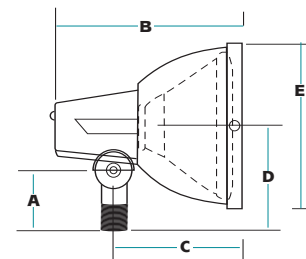

A	B	C	D	E
1.94"	6.0"	4.06"	3.44"	5.38"



A HUBBELL LIGHTING, INC. COMPANY

Performance Designed Lighting Products

[www.securitylighting.com](http://www.securitylighting.com)

1085 Johnson Drive • Buffalo Grove, IL 60089 • TOLL-FREE: 800-544-4848 • PHONE: 847-279-0627 • FAX: 847-279-0642

## HID BULLET/BELL LAMPHOLDER ACCESSORIES

Underground junction boxes, conduit staffs and ground spikes to complete any custom landscape installation.

### RIGID STAFFS

- 1/2" NPT conduit threaded both ends
- Green or black Lektrocote® finish

### HEAVY-DUTY BOXES

- Cast construction with covers, hardware, and waterproof gasketing
- Suitable for above or below ground installations

### HEAVY GROUND SPIKES

- Rigid cast construction for portable installations

## ACCESSORIES

Must be ordered separately

Catalog Number	Description	Weight	
		lbs.	kg
<b>CONDUIT STAFFS</b>			
<b>GLN-1-G</b>	1/2" Conduit Staff, 14" long, green	1.0	0.5
<b>JUNCTION BOXES</b>			
<b>NM-BC</b>	Non-metallic High Impact Phenolic Weatherproof Box & Cover box is drilled at 180° for two burial cable connectors which are included allowing feed-thru capability; gasket cover has weathertight 1/2" hub; brass cover screws; gray		
<b>1414</b>	Cast Iron Box - 2 side hubs, one top (1/2") heavy-duty, gray	5.0	2.3
<b>GROUND SPIKES</b>			
<b>1031-3</b>	Cast Spike with internal splice box; 1/2" NPSM hub for fixture & 6' #18/3 grounded cord set; gray	1.75	0.8
<b>1034</b>	Cast Spike with 1/2" NPSM threaded hub; gray	0.25	0.1
<b>FITTER</b>			
<b>S-302</b>	Slipfits 1 1/2" or 2" pipe (1.9" OD or 2 3/8" OD) with 1/2" NPSM hub; gray	1.0	0.5



GLN-1-G

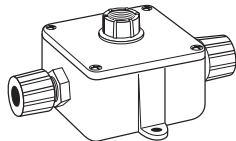

NM-BC

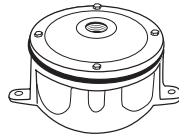

1414

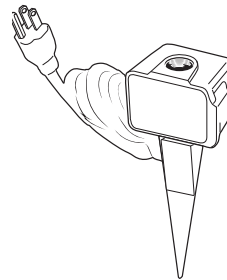

1031-3



1034

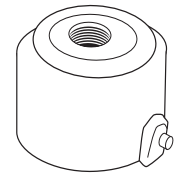

S-302

## ACCESSORIES (103 SERIES ONLY)

Must be ordered separately

Catalog Number	Description	Weight	
		lbs.	kg
<b>1048'</b>	Lens Holder attaches to outside of lampholder, 103-7 Series only	0.125	0.1
<b>1052-C</b>	Clear Lens, must order 1048 lens holder	0.125	0.1
<b>1324</b>	Zinc Plated Wire Guard, for PAR-38 lamps only	0.5	0.3
<b>1031-3</b>	Ground Spike with integral splice box & 6' #18/3 cord set & 1/2" NPSM hub	2	0.9

† 1048 lensholder cannot be used with PAR-38 lamp. When using lens, R-30, A-21 or smaller lamp must be used.



A HUBBELL LIGHTING, INC. COMPANY

Performance Designed Lighting Products

www.securitylighting.com

1085 Johnson Drive • Buffalo Grove, IL 60089 • TOLL-FREE: 800-544-4848 • PHONE: 847-279-0627 • FAX: 847-279-0642